

OPTIMUS PRIME



Pack 03

組裝說明

ASSEMBLING THE FINGERS
ASSEMBLING THE THUMB
ASSEMBLING THE LEFT HAND
ASSEMBLING THE LOWER LEFT ARM

AGORA
MODELS®

Advice from the experts

 **Please keep ALL unused screws as they may be required in a later stage.**

Please make sure you don't mix up the screws. They look quite similar, but the threads do vary slightly. Using the wrong screws may damage the parts.

When securing parts together using multiple screws, fit each screw loosely to ensure all the parts are correctly aligned before gently tightening them firmly, but not overtight, in the order in which you placed them.

The screwdriver can be magnetized by stroking it with a magnet (fridge magnet, etc.) enabling it to hold the screws and make assembly easier.

If a screw is tight going into a metal part, do not force it as you may shear the head off. Remove it and put a tiny smear of Vaseline, soap or light oil on the thread. That will lubricate it and make it easier to drive home.

Some parts will require a little glue for assembly. Please apply glue sparingly and use a cocktail stick so that you don't use too much nor apply the glue too heavily. We recommend superglue gel or Extra Thin Liquid modeling glue. Where possible, parts should be test-fitted in place before gluing.



Look out for the glue symbol and apply glue to the red area indicated in the picture.

During the course of this build, you will receive many pieces that you will assemble immediately – following the instructions in the corresponding stage – and other pieces that you should store in the tray supplied, for use in future assembly stages.

Always protect the paint finish on components by placing a cutting mat, sheet of white paper or soft cloth on your work surface.

Left and Right! When building your Optimus Prime, the left or right hand side refers to each side as viewed by Optimus Prime. Optimus Prime's left arm is on the viewer's right.



WARNING: Some parts are assembled using magnets. These magnets can cause serious injury if they are swallowed. Keep away from children. If you suspect a magnet has been swallowed, seek medical help straight away.

Pack 3 Parts

TRAY 1

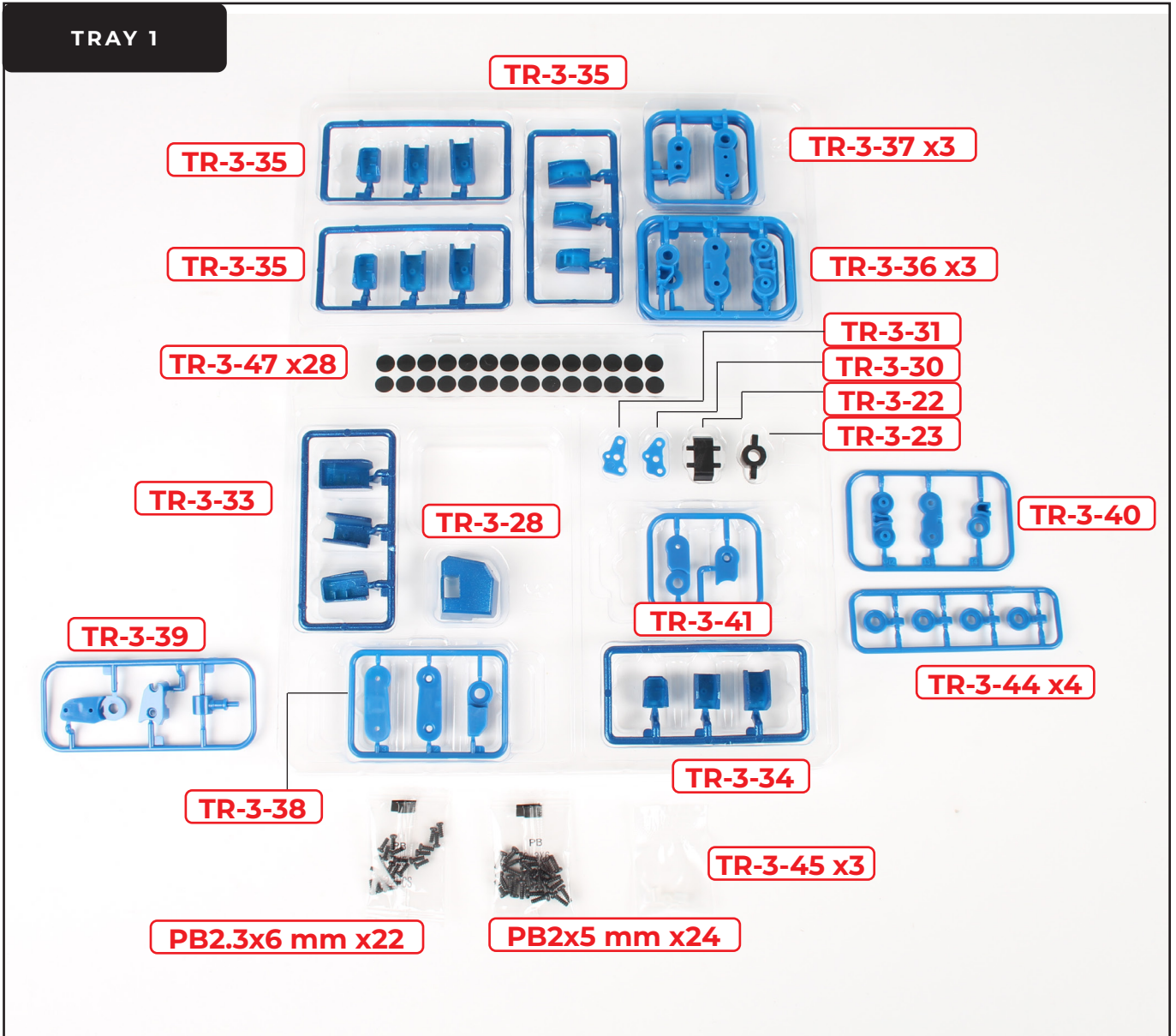

Pack 3 Parts

TRAY 2

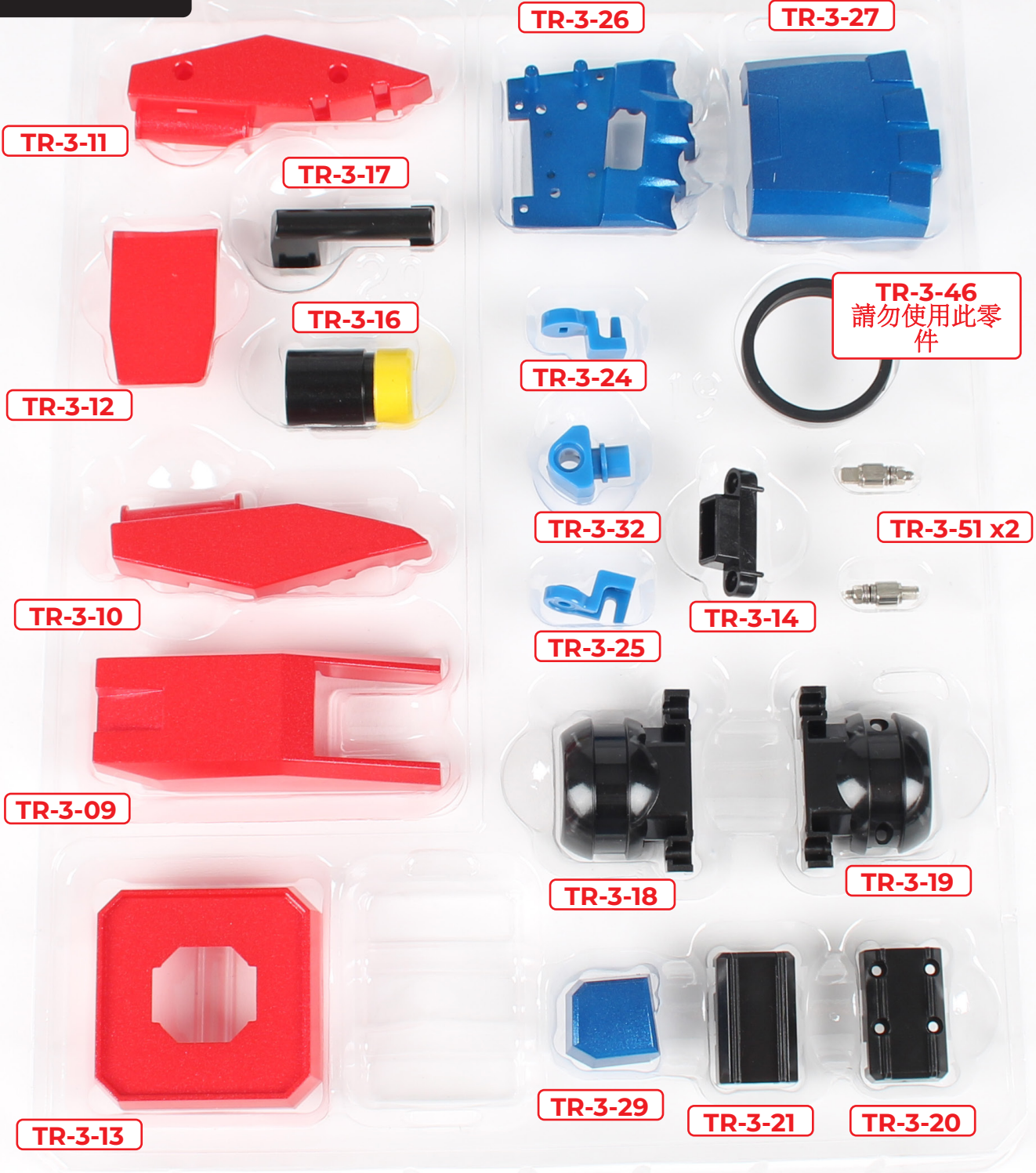

TR-3-46
請勿使用此零件

警告：
請勿使用零件TR-3-46。請使用另外提供在獨立袋中的替代零件。請注意，確保不要混淆零件。

**PWM 2x5.5 mm
x11**



**PWB 2x6 mm
x5**



Pack 3 Parts

TRAY 3

TR-3-03

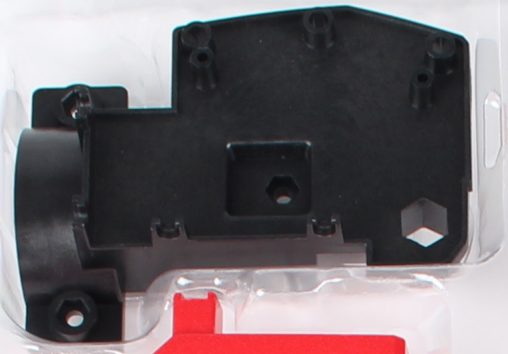

TR-3-01



TR-3-07



TR-3-02



TR-3-15



TR-3-08



TR-3-05



TR-3-04

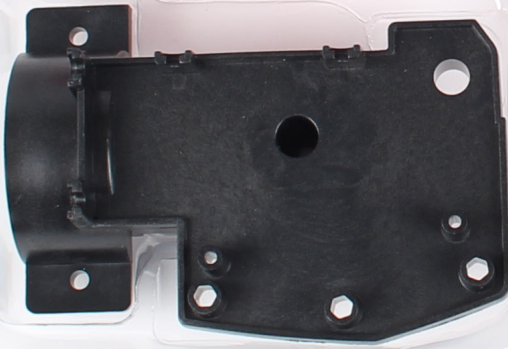

TR-3-06



TR-3-50 x3



M3x12 mm x3



TR-3-49 x4



組裝拇指

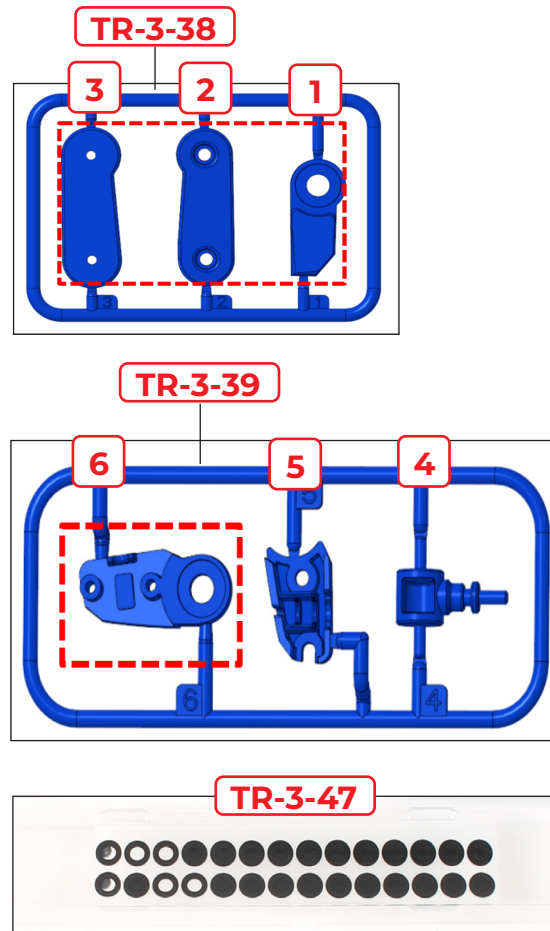
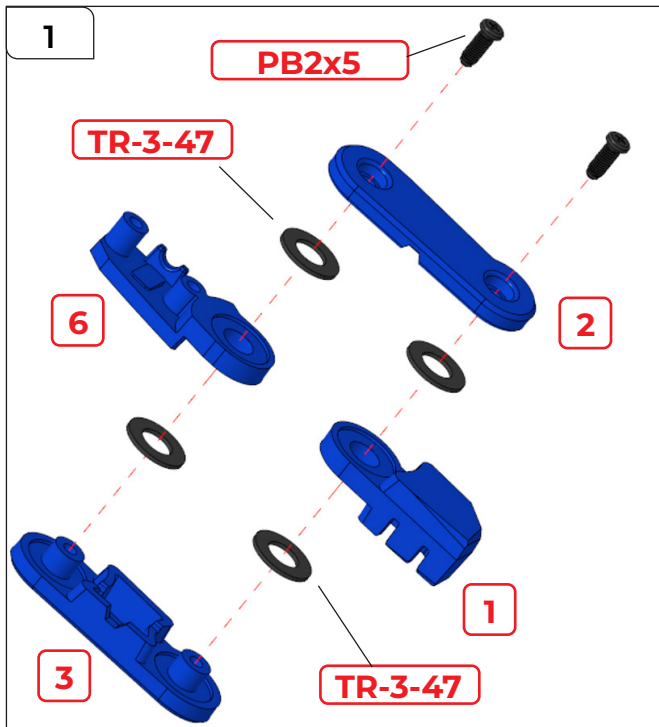

STEP 1

注意：在從模型框上取下零件時，我們建議將其折斷，而不是使用模型框剪刀，以保護塗裝。

從模型框TR-3-38上折斷No.s 1、2和3。

從模型框TR-3-39上折斷No. 6。

將2顆TR-3-47放在3上。

將2顆TR-3-47放在1和6上。

將1和6放在3上。反覆擺動它們以確保緊密配合，否則在後續階段將無法適配外殼。

將2放在1和6上，然後使用2顆PB2x5mm螺絲固定組件。

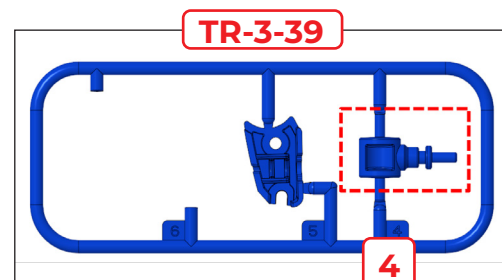
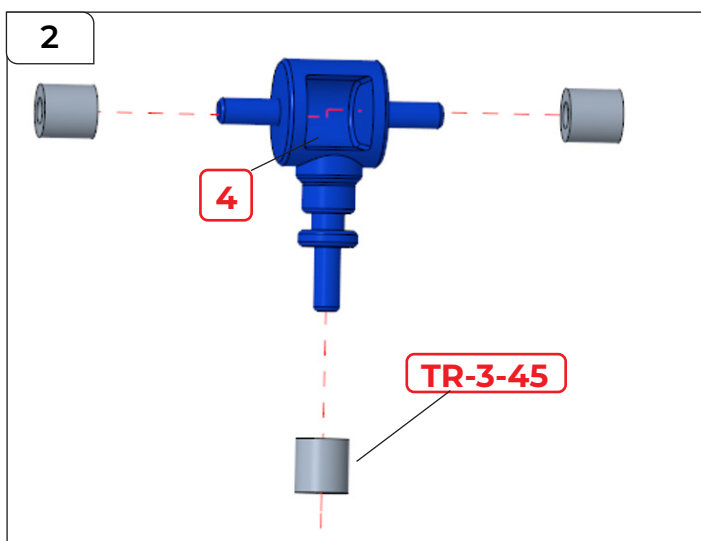

STEP 2

從模型框TR-3-39上折斷No. 4。
將3顆TR-3-45放在4上。

組裝拇指

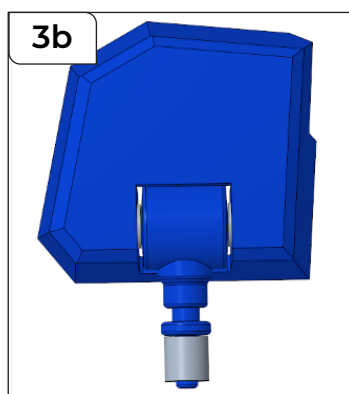
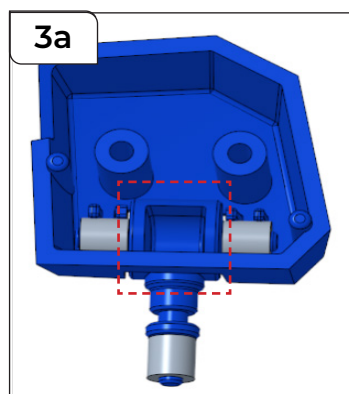
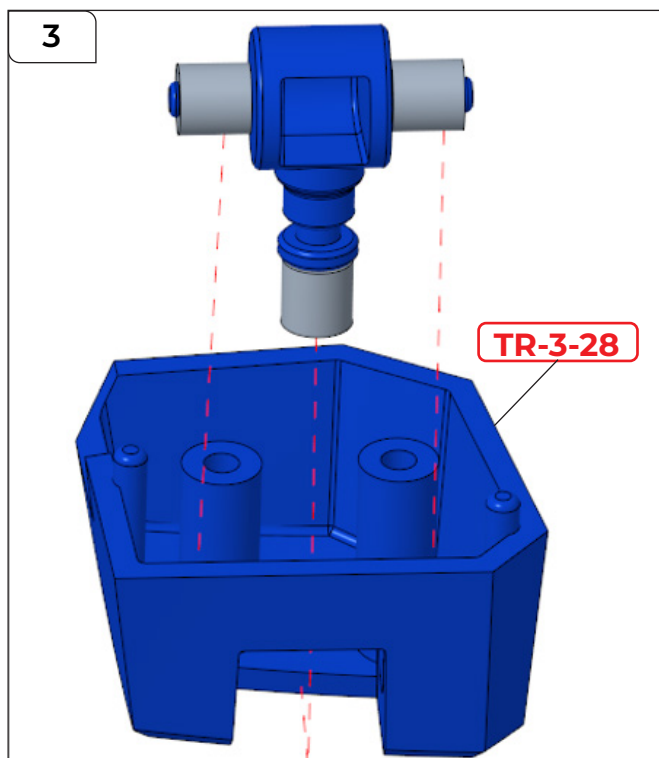

STEP 3

將步驟2的組件放在TR-3-28上，特別注意方向，如3a和3b所示。

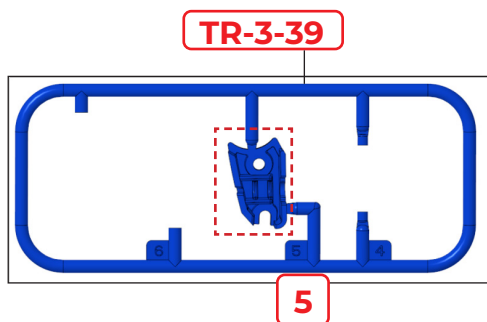
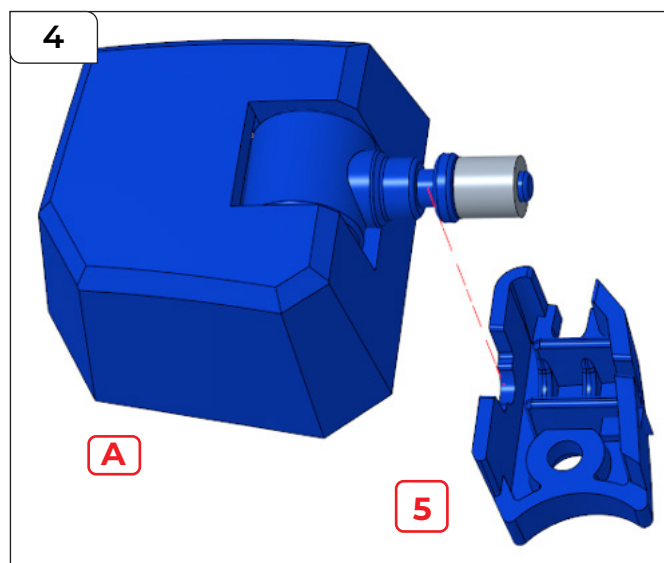

STEP 4

從模型框TR-3-39上折斷No. 5。
將5放在A上。

組裝拇指

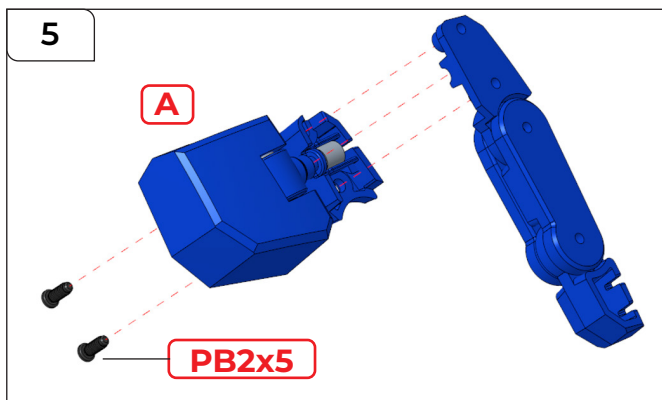

STEP 5

將A附著到步驟1的組件上，然後使用2顆PB2x5mm螺絲將零件固定在一起。

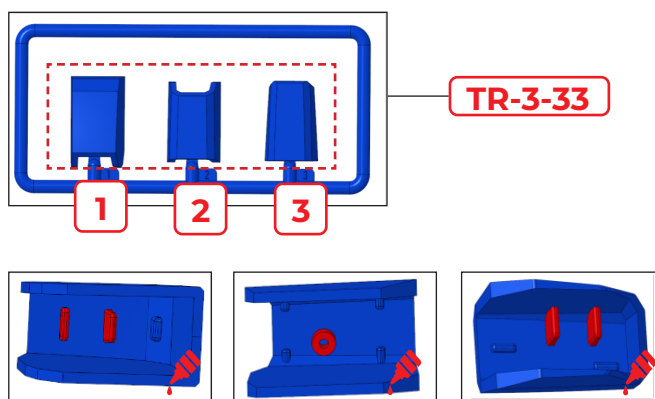
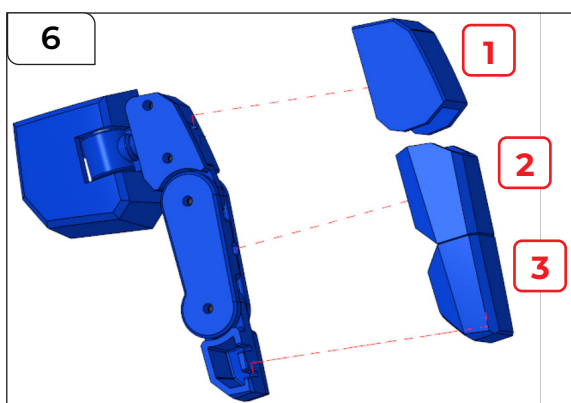

STEP 6

從模型框TR-3-33上折斷No.s 1、2和3，按照示意點擦上膠水。按照示意將其固定到步驟5的組件上。

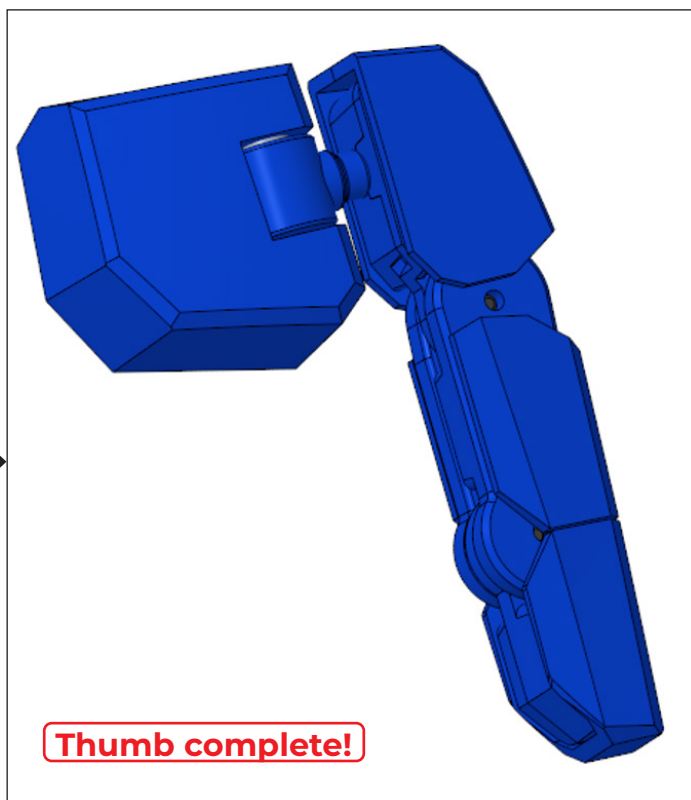
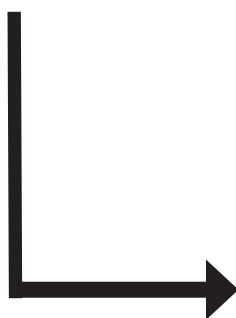

組裝手指

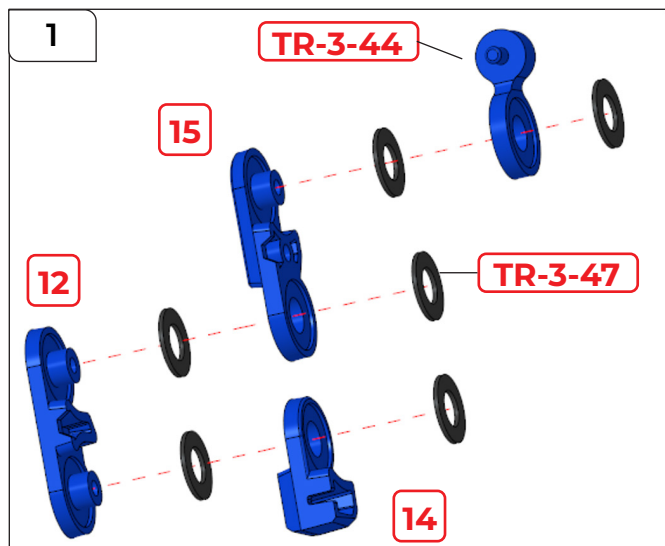

STEP 1

從模型框TR-3-40上折斷No.s 12和14。從TR-3-41上折斷No. 15。從TR-3-44上折斷1塊。

將2顆TR-3-47放在12和15上。將1顆TR-3-47放在14和TR-3-44部分上。將14和15固定在12上。將TR-3-44固定在15上。

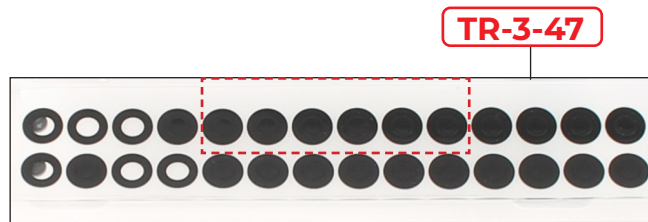
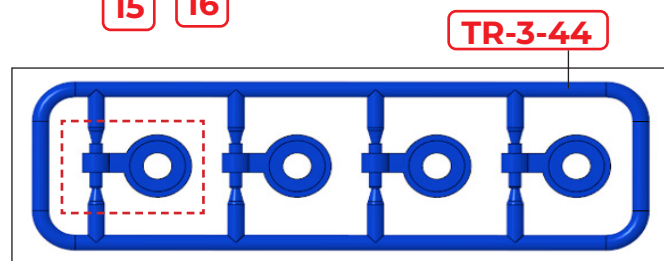
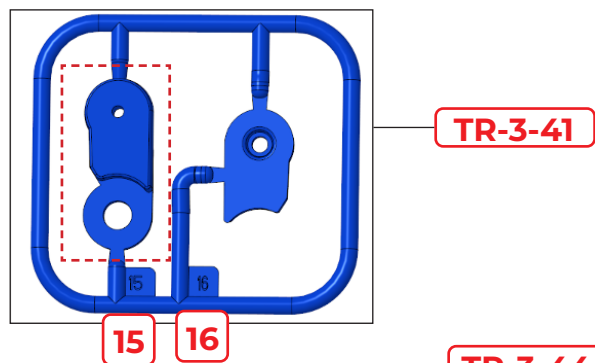
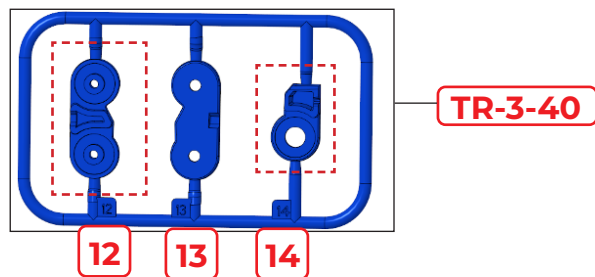

組裝手指

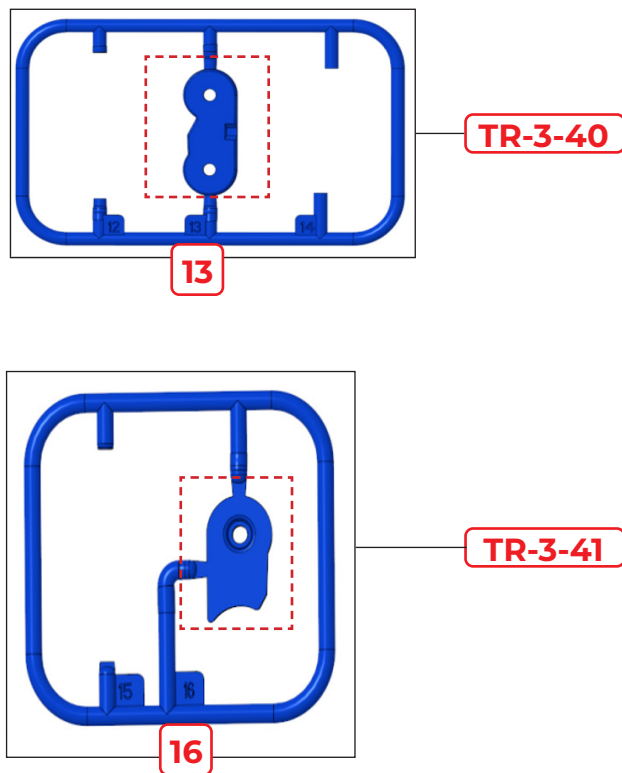
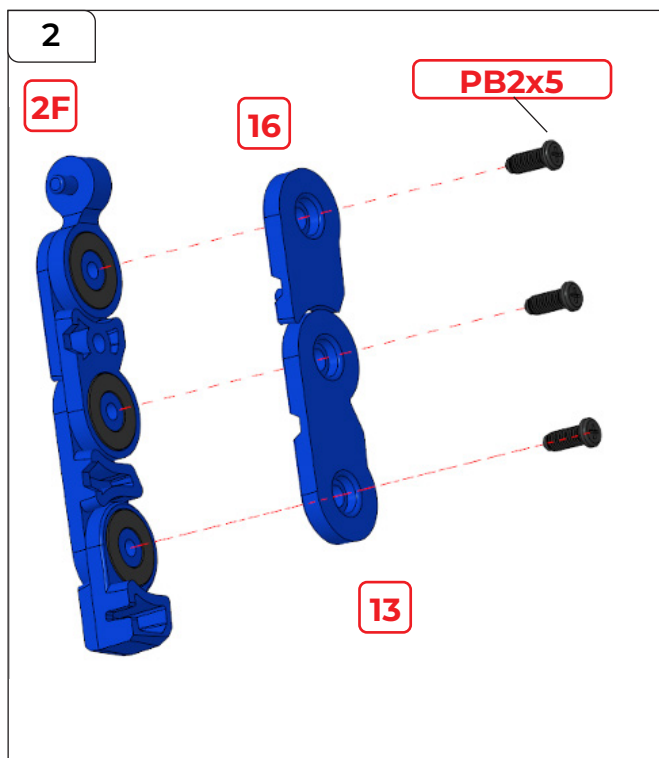

STEP 2

從TR-3-40上折斷No. 13。
 從TR-3-41上折斷No. 16。
 將13和16固定到2F上，並使用3顆PB2x5mm螺絲將它們固定。

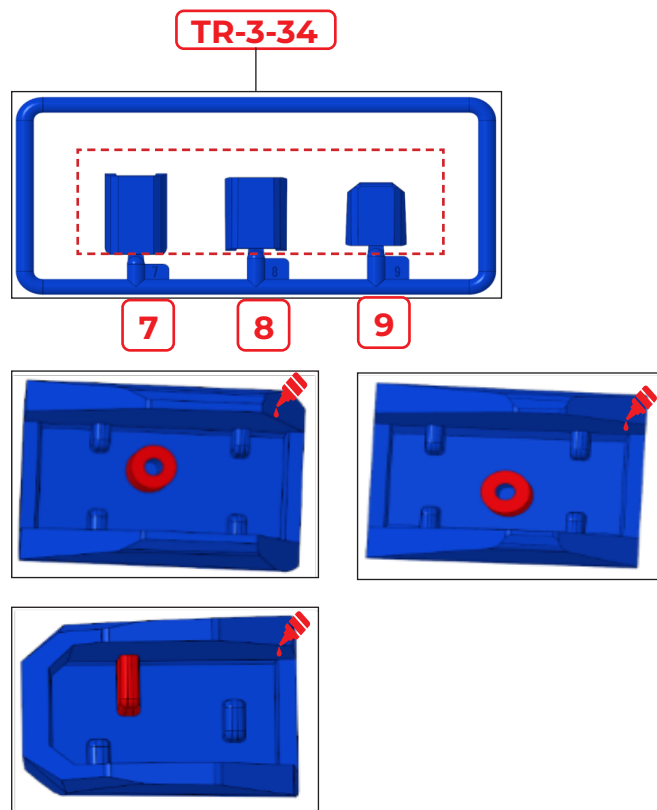
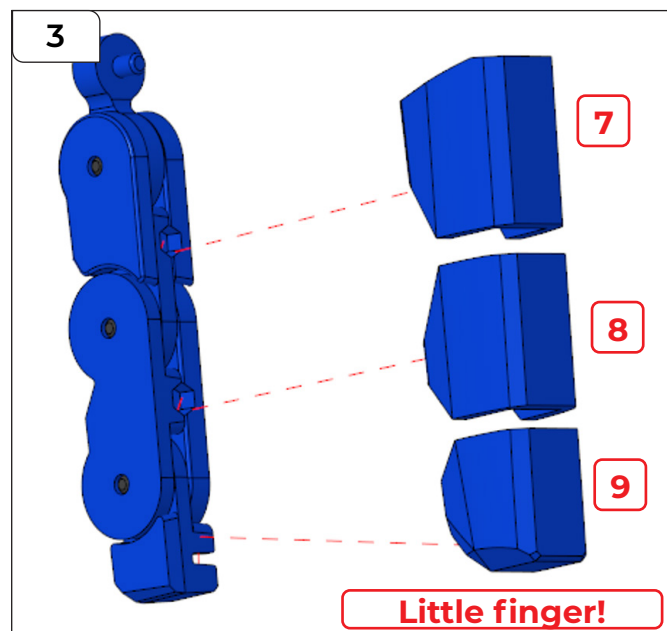

STEP 3

從模型框TR-3-34上折斷No.s 7、8和9。
 按照示意點擦上膠水。
 按照示意將7、8和9固定到步驟2的組件上。

組裝手指

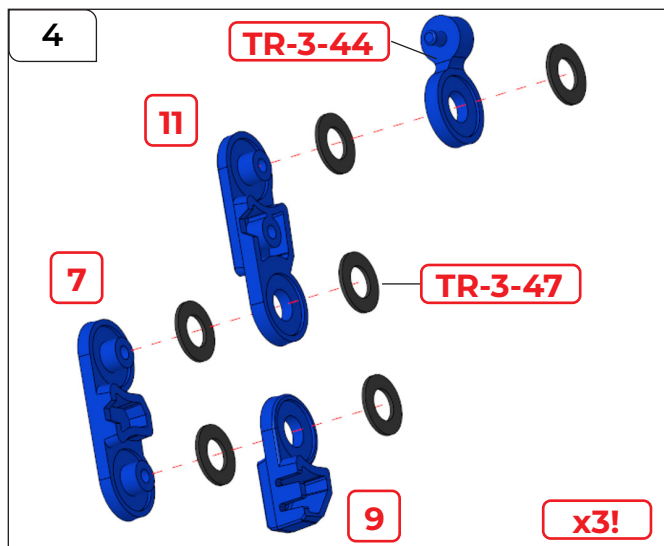

STEP 4

從模型框TR-3-36上折斷No.s 7和9，從TR-3-37上折斷No. 11，從TR-3-44上折斷1塊。將2顆TR-3-47放在7和11上，將1顆TR-3-47放在9和TR-3-44上。將9和11附著到7上，將TR-3-44附著到11上。

重複步驟4以製作3套。

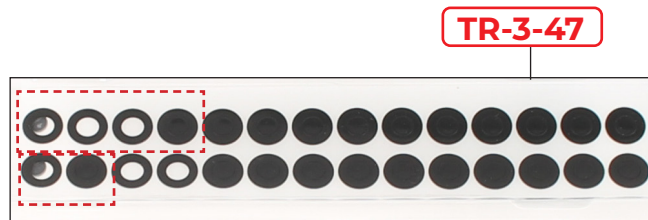
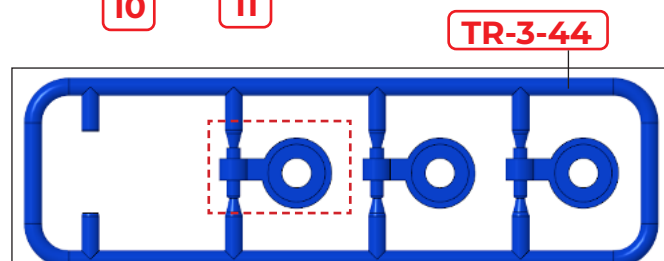
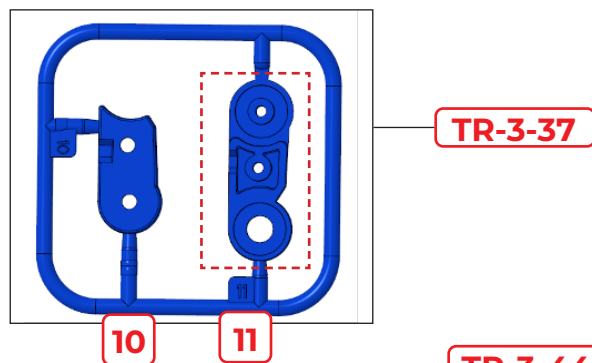
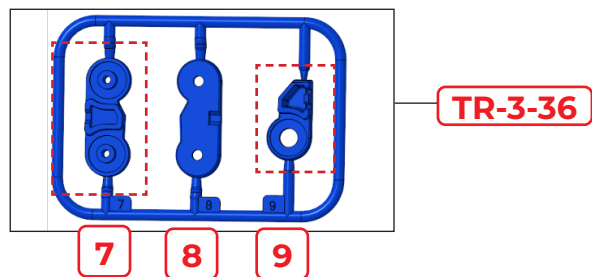

組裝手指

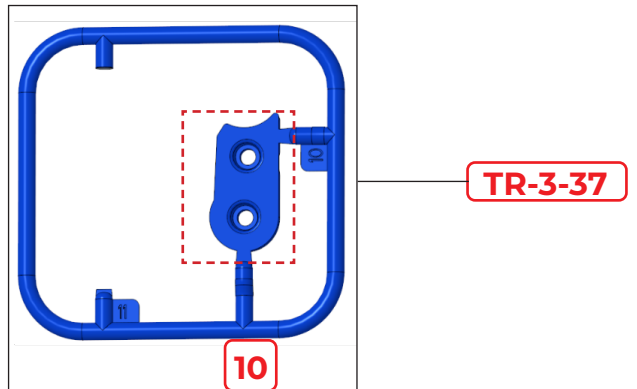
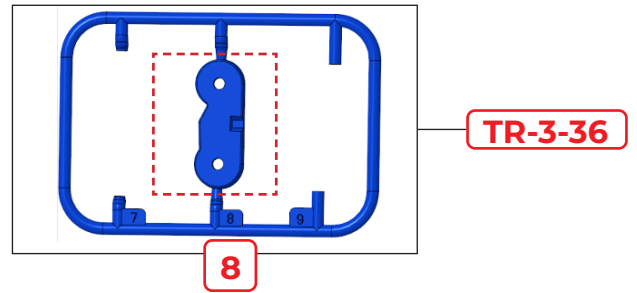
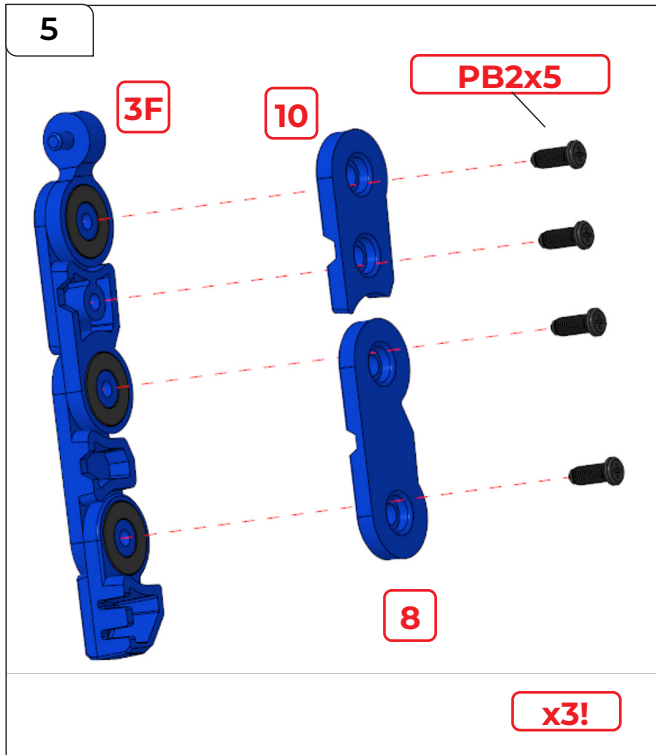

STEP 5

從模型框TR-3-36上折斷No. 8，從TR-3-37上折斷No. 10。將8和10附著到步驟4的組件上，並使用4顆PB2x5mm螺絲固定。重複此步驟以製作3套。

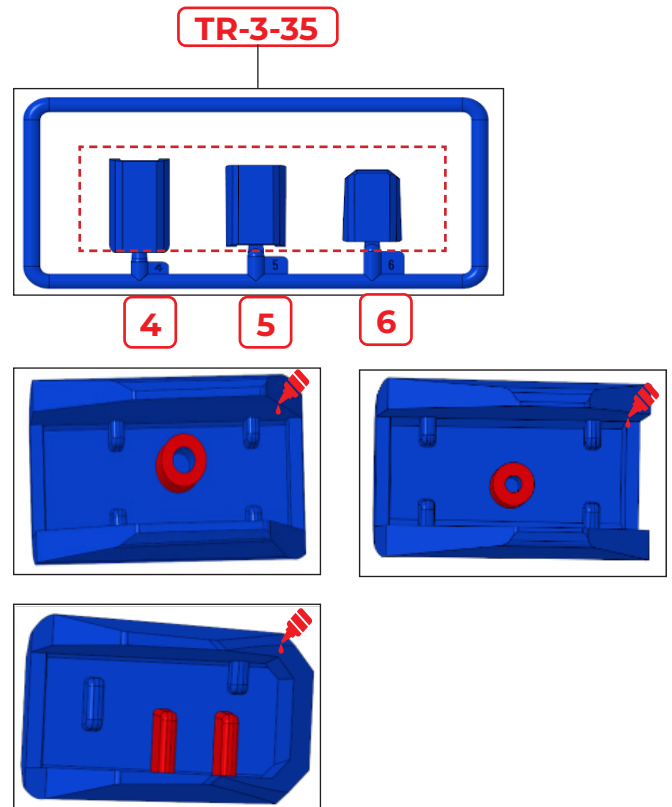
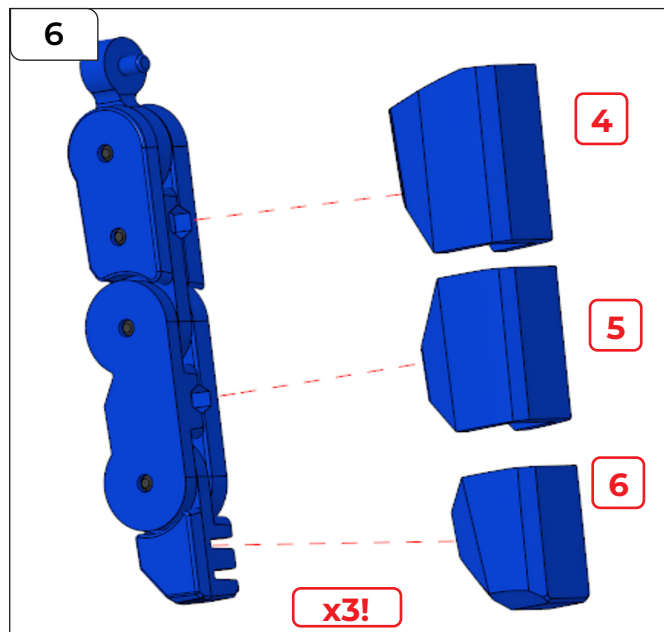

STEP 6

從模型框TR-3-35上折斷No.s 4、5和6。
按照示意點擦上膠水。
按照示意將4、5和6固定到步驟5的組件上。重複3次以完成3套手指組件。

組裝手指

7

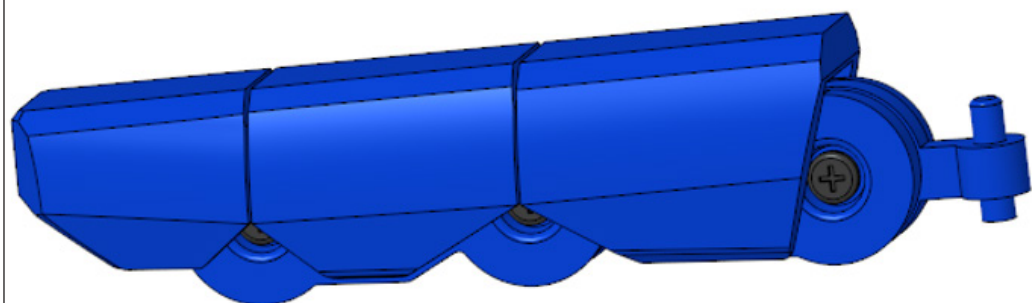

STEP 7

完成的三套手指組件如圖所示。

組裝左手

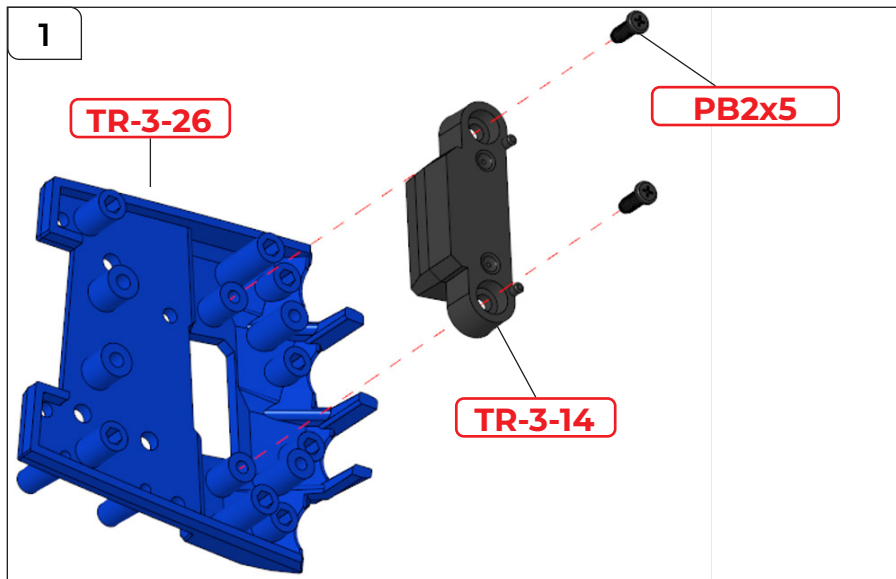

STEP 1

將TR-3-14固定到TR-3-26上，使用2顆PB2x5mm螺絲將它們固定在一起。按照下面的示意附著小指和3套手指。請注意，在這一步和接下來的一步中，您可能會發現一次附著兩個相鄰的手指比同時附著所有四個手指更容易。

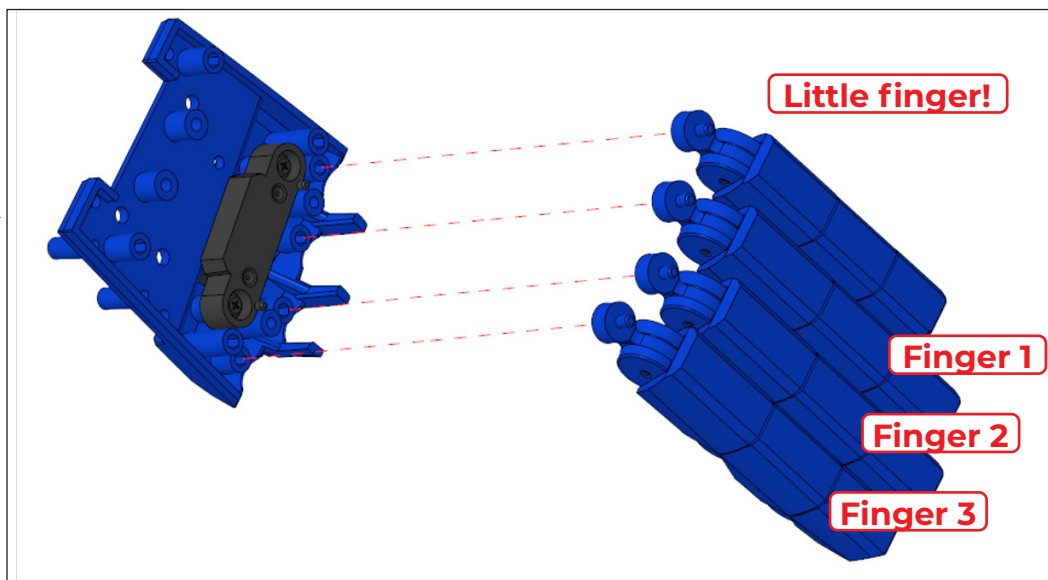

組裝左手

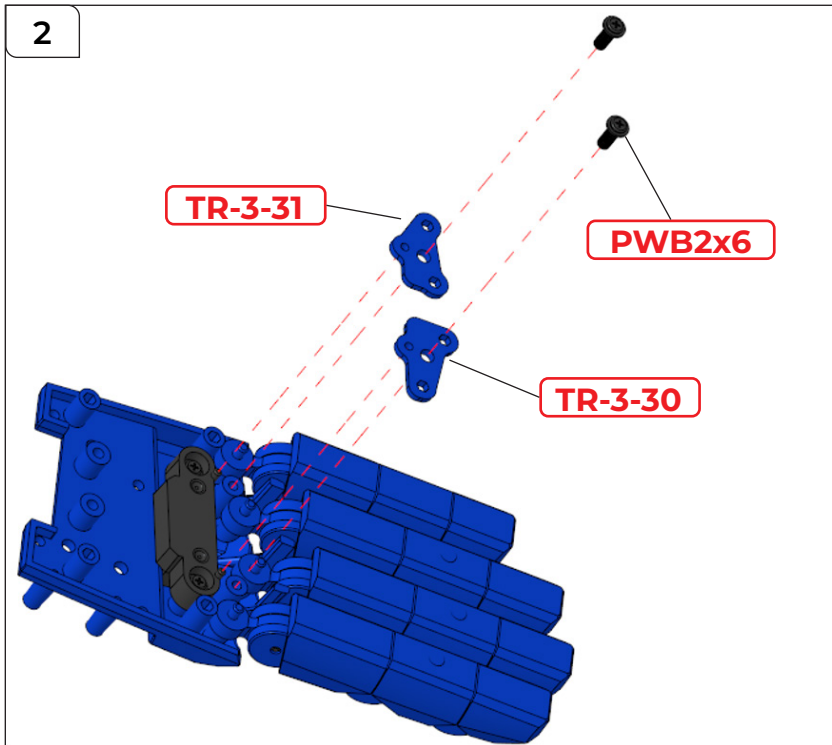

STEP 2

將TR-3-31和TR-3-30附著到步驟1的組件上，並使用2顆PWB2x6mm螺絲將它們固定。
然後將拇指附著到手掌上，使用2顆PB2.3x6mm螺絲將它們固定。

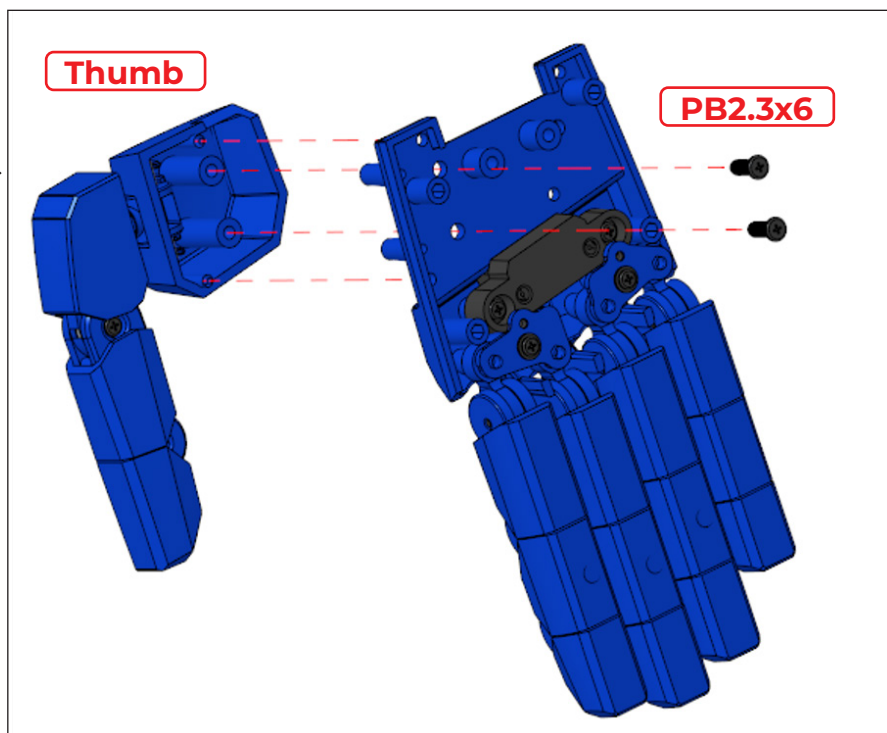

組裝左手

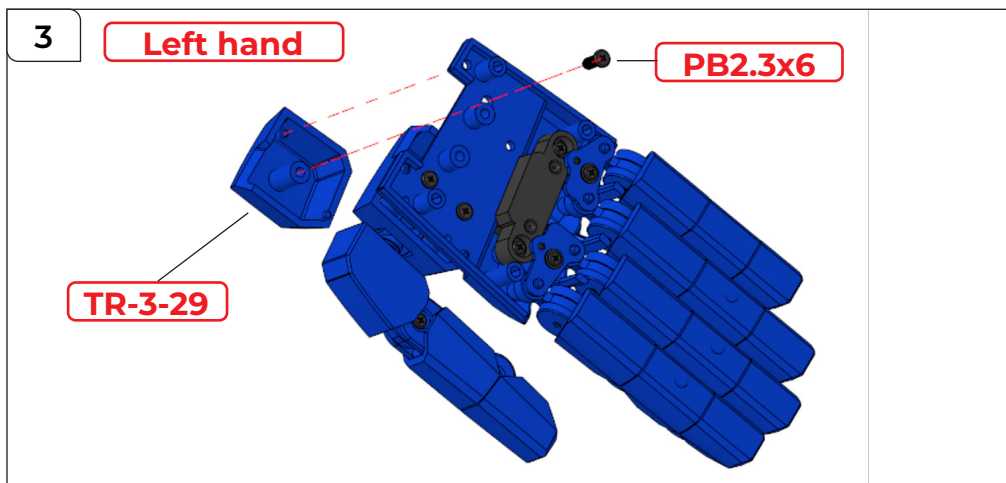

STEP 3

按照示意將TR-3-29附著到左手上。使用1顆PB2.3x6mm螺絲與拇指一起固定在位。

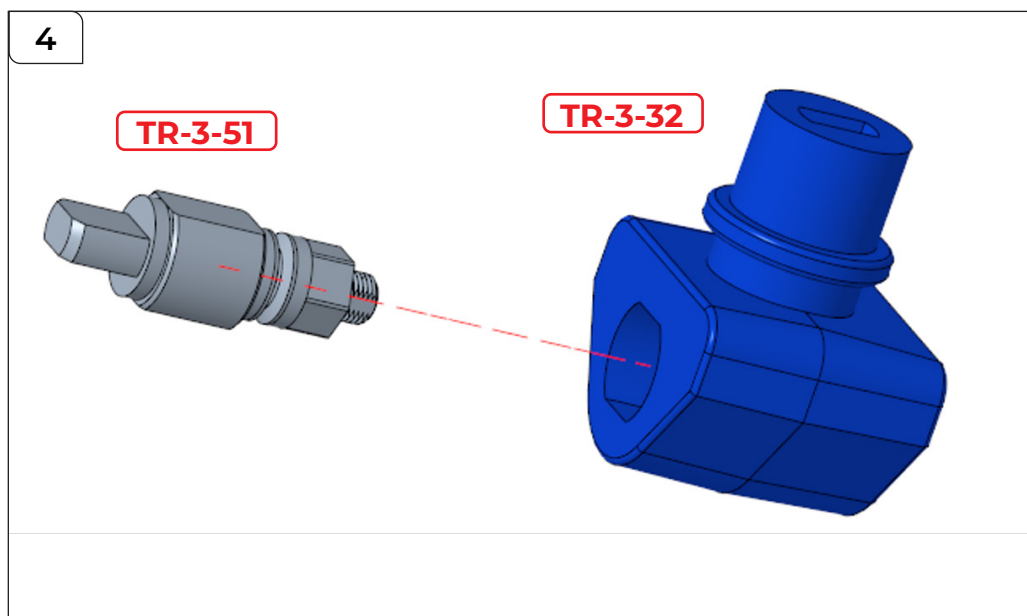

4a

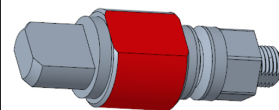

4b

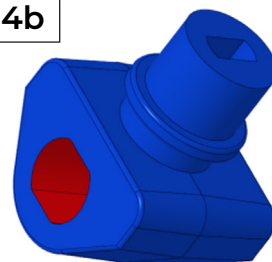

STEP 4

將 TR-3-51 插入 TR-3-32 中，請依照紅色部分在 4a 和 4b 圖示中所示的方向檢查零件的朝向。您可能需要一把小型鐵鎚來輔助安裝。

組裝左手

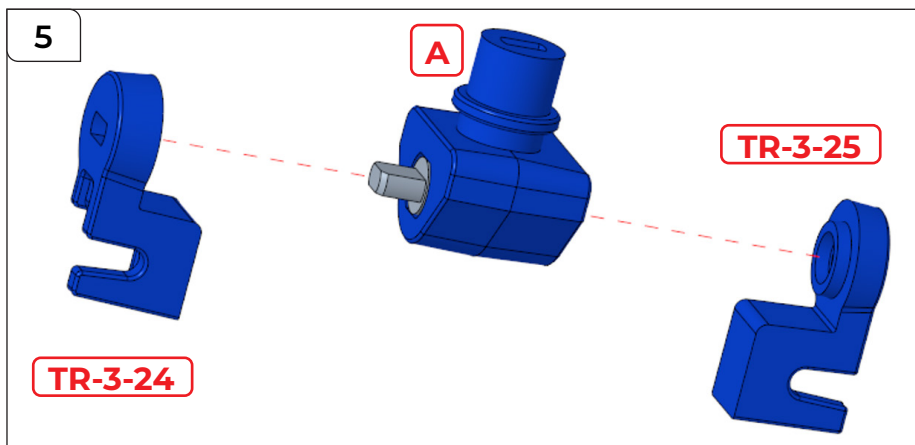

STEP 5

按照示意將TR-3-24和TR-3-25附著到A上。
然後將組件使用2顆PB2.3x6mm螺絲固定到手部(B)上，如下所示。

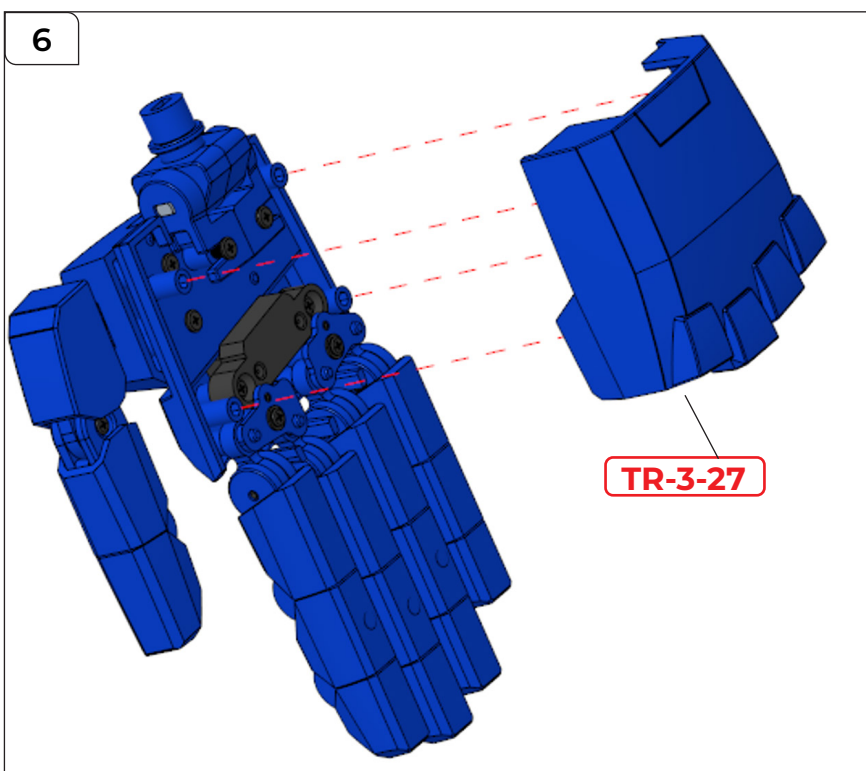
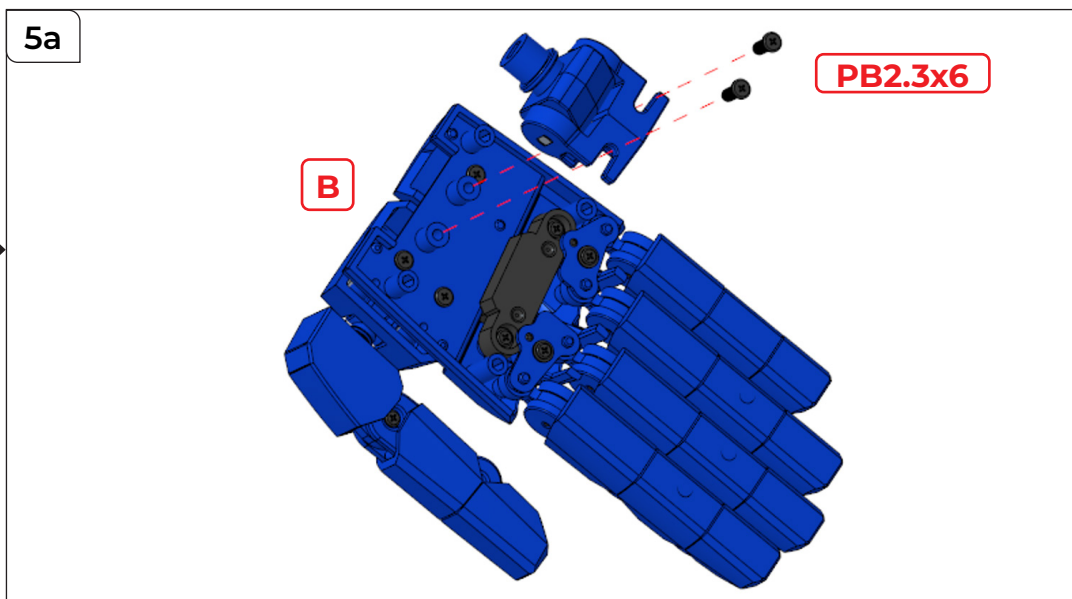

STEP 6

按照下面的示意在TR-3-27上塗上少量膠水，然後將其附著到手部組件上。

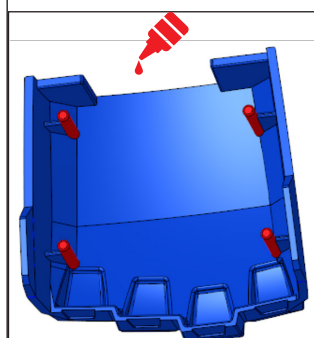

組裝左手

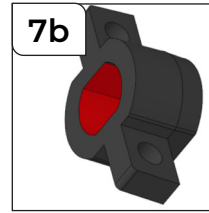
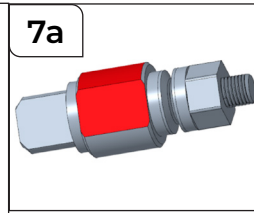
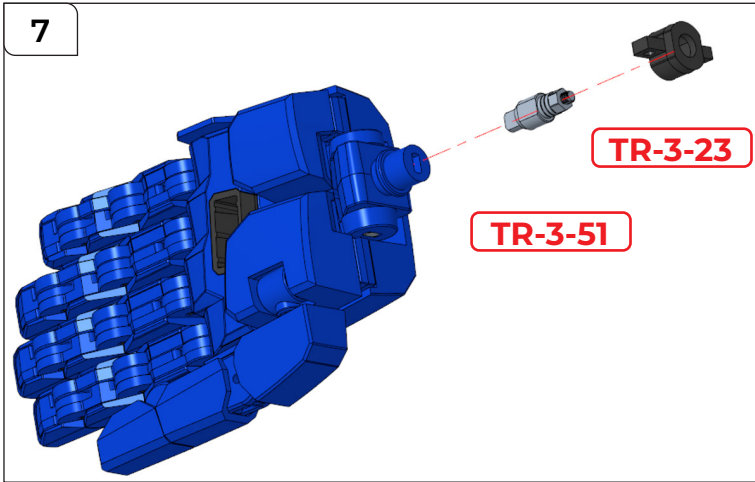

STEP 7

依照圖示將 TR-3-51 和 TR-3-23 連接到左手，請參考 7a 和 7b 圖中的方向檢查零件的朝向。

然後，將 TR-3-22 放置在 TR-3-20 上，接著依照圖示將 TR-3-20 連接到手上的 TR-3-23 上。使用 2 顆 PWB2x6 mm 螺絲固定零件。

注意：TR-3-22 將在下個步驟固定到位。

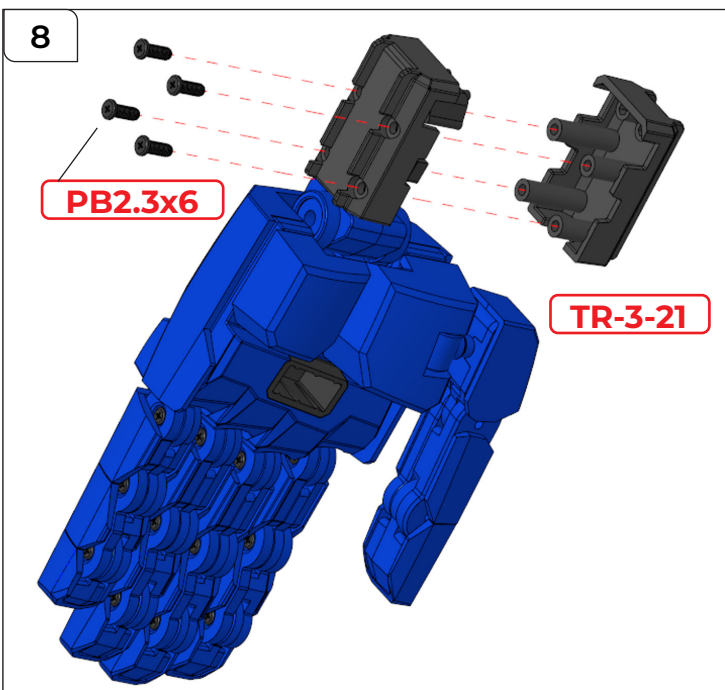
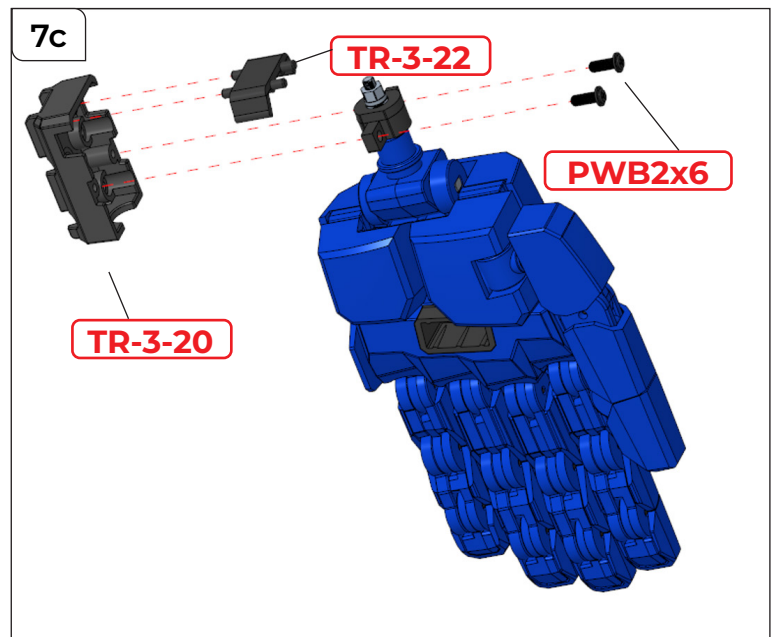

STEP 8

按照示意將 TR-3-21 附著到手部，使用 4 顆 PB2.3x6mm 螺絲將其固定在位。

組裝左下臂

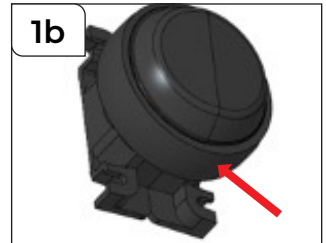
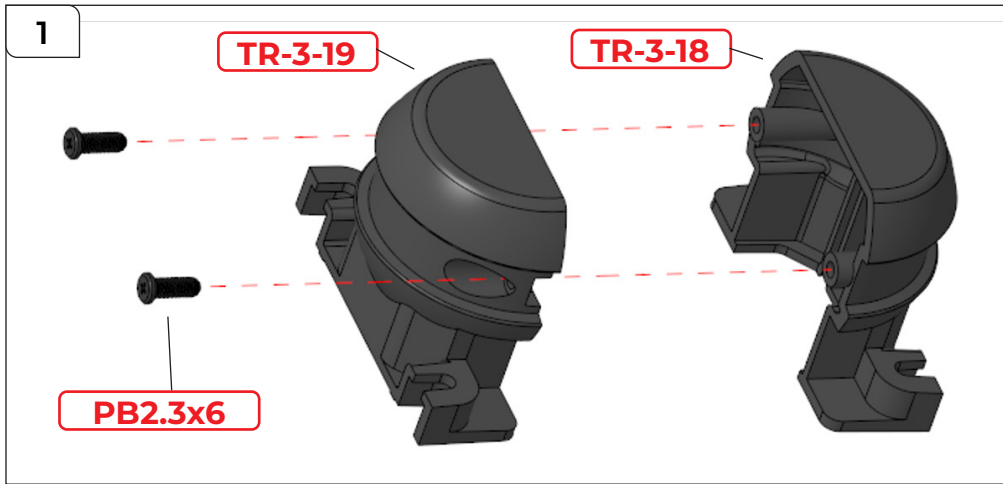

STEP 1

將 TR-3-19 和 TR-3-18 連接在一起，使用 2 顆 PB2.3x6 mm 螺絲固定。

警告：本步驟使用的零件 TR-3-46 已升級。
請使用單獨袋子中標有 TR-3-46 NEW 的新零件。

將 TR-3-46 NEW 推入 A 上的凹槽中（在 1b 中顯示位置）。

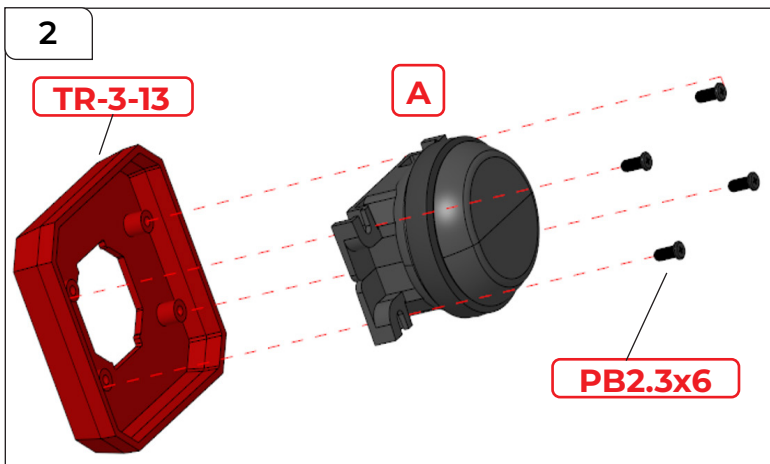
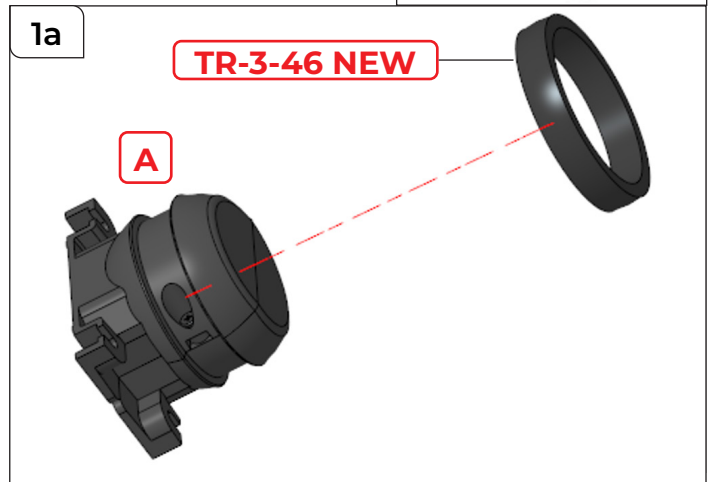

STEP 2

將 TR-3-13 附著到 A 上，使用 4 顆 PB2.3x6 mm 螺絲將其固定在位。

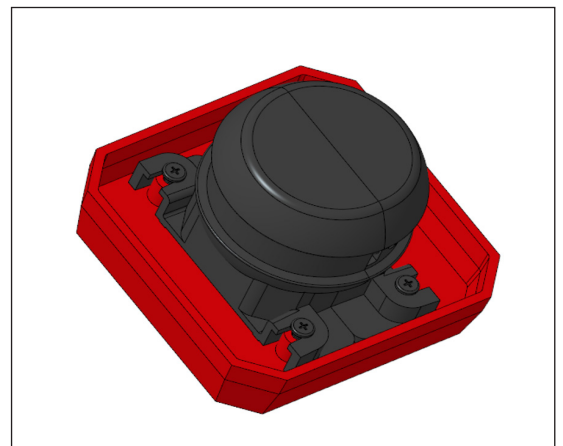

組裝左臂

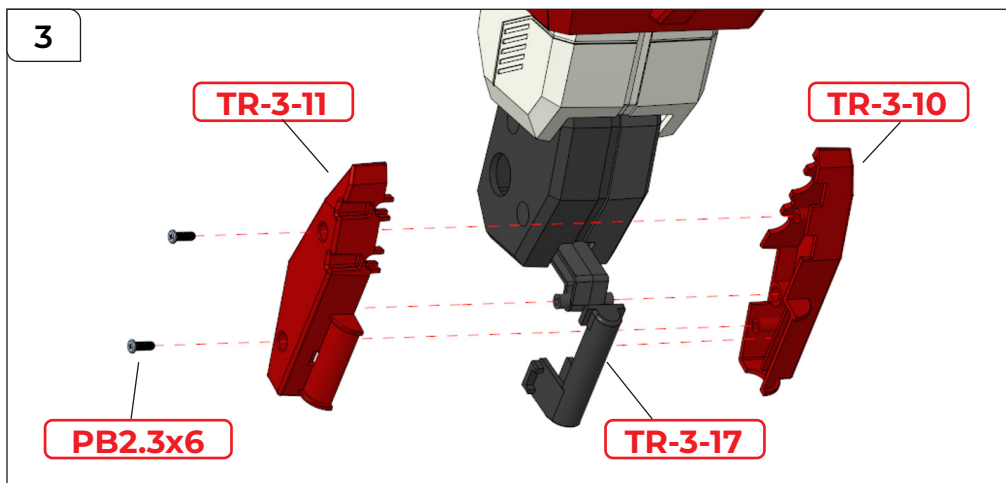

STEP 3

將來自零件包 2 的 TR-3-11、10 和 17 連接到左手臂。右側的圖片顯示了這些零件的正確方向。使用 2 顆 PB2.3x6 mm 螺絲將它們固定在一起。

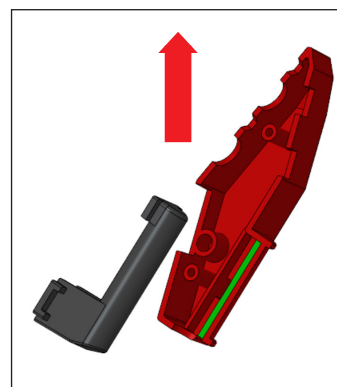
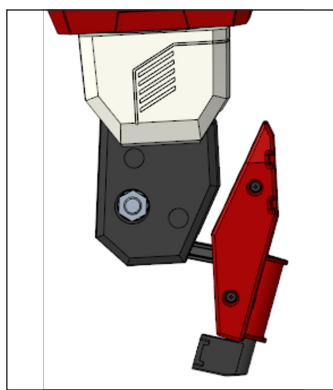

在開始下一步之前，按照下面顯示的方向排列左臂的底部部分。

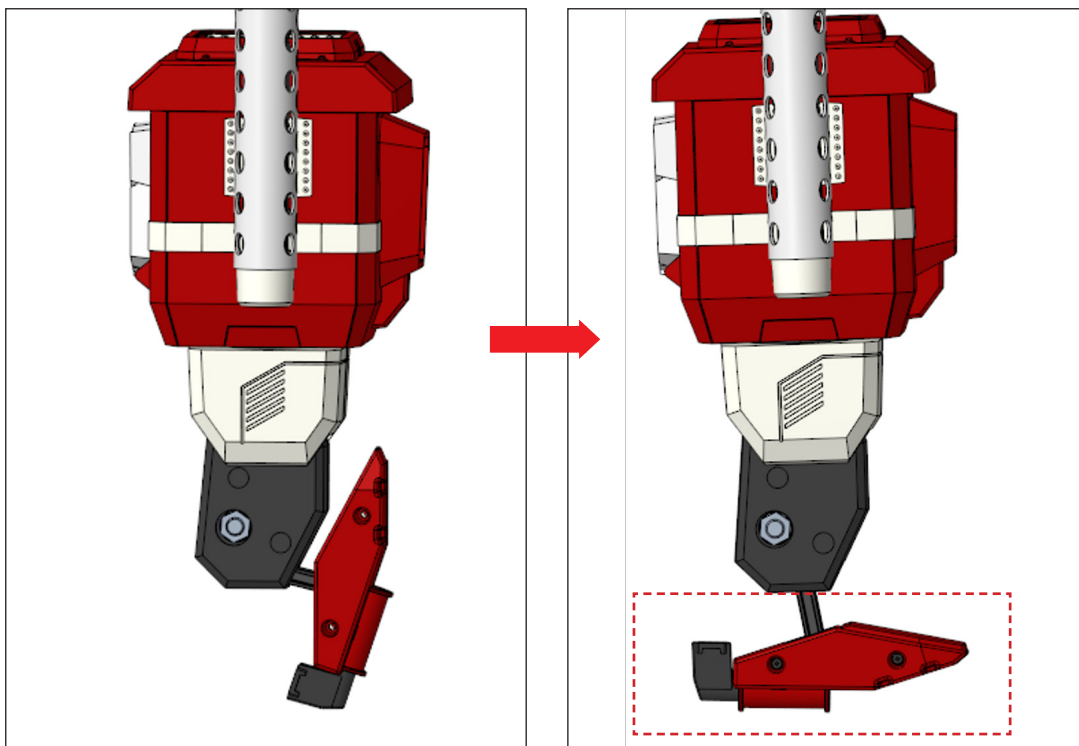

組裝左下臂

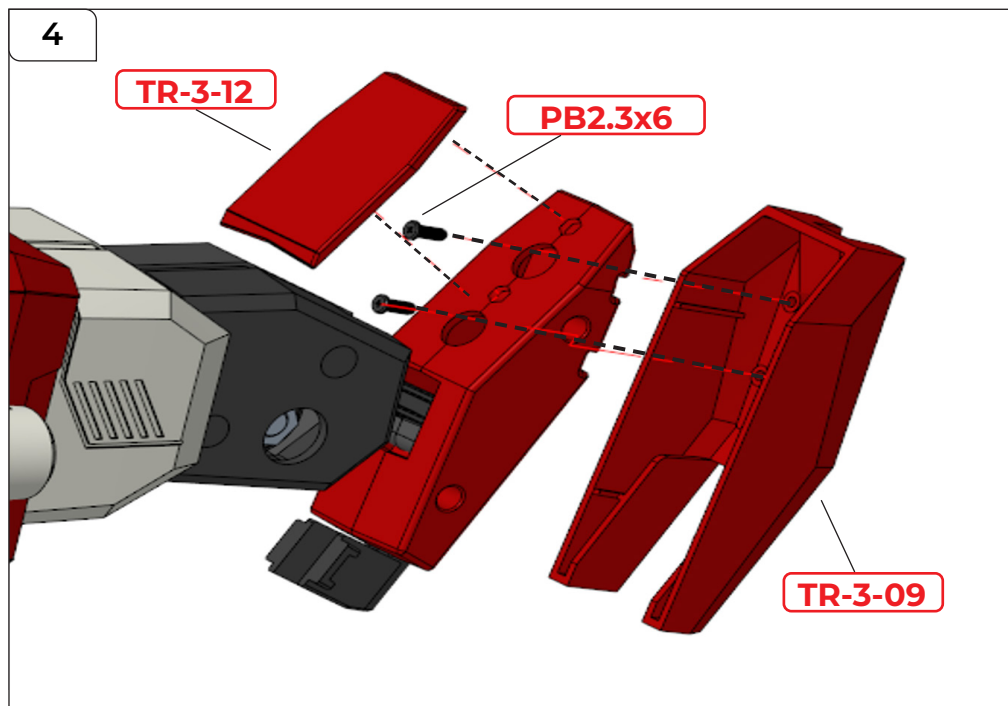

STEP 4

將 TR-3-09 固定到手臂組件上，並使用 2 顆 PB2.3x6 mm 螺絲將其固定到位。依照圖 4 所示將 TR-3-12 固定在手臂上。

組裝左下臂

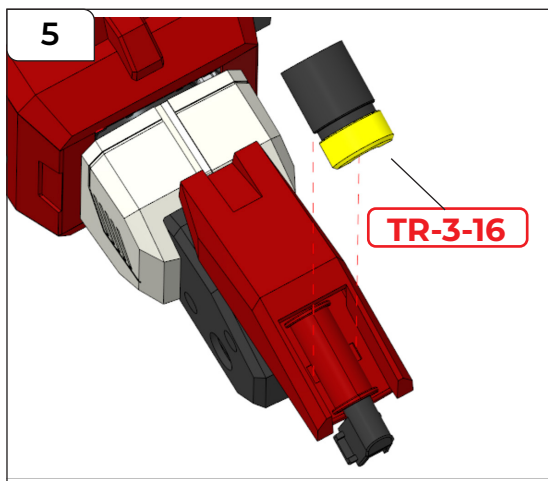

STEP 5

將TR-3-16附著到手臂上。

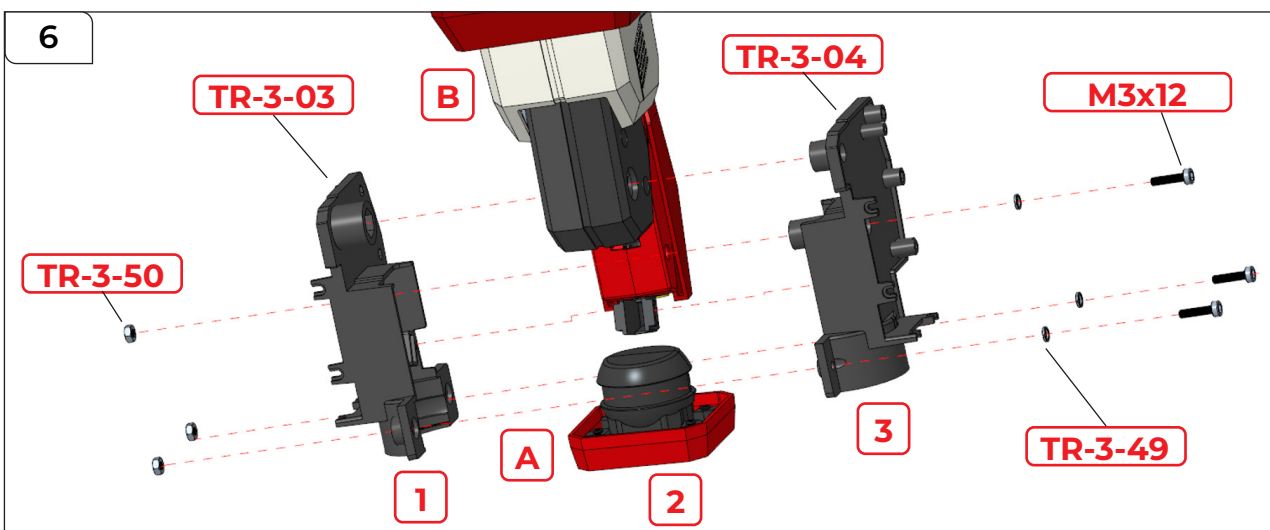

STEP 6

將組件 A、TR-3-03 和 TR-3-04 連接到組件 B 上。
將 3 個 TR-3-49 螺紋旋入 3 個 M3x12 mm 螺絲上。
然後按照圖示將它們穿過螺絲孔。
使用 3 個 TR-3-50 螺帽將其固定到位。

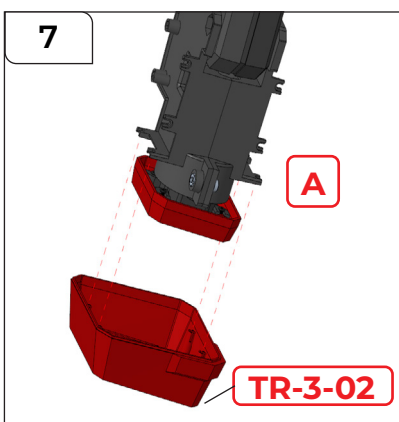

STEP 7

將 TR-3-02 連接到 A 上，如圖 7 所示。使用 4 顆 PWM2x5.5 螺絲將其固定到位。

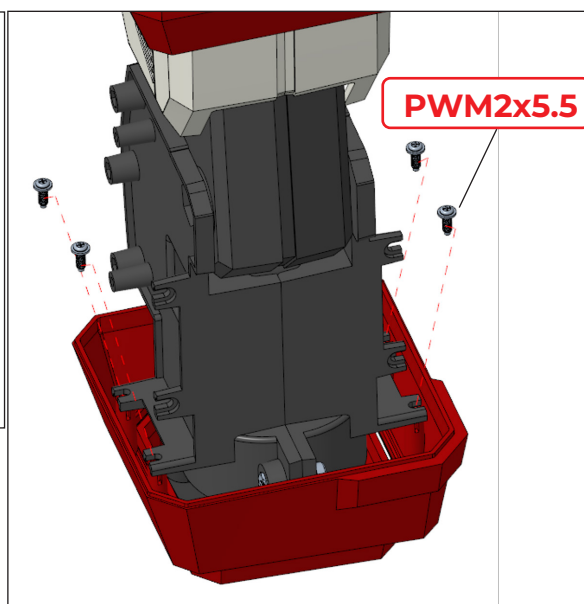

組裝左下臂

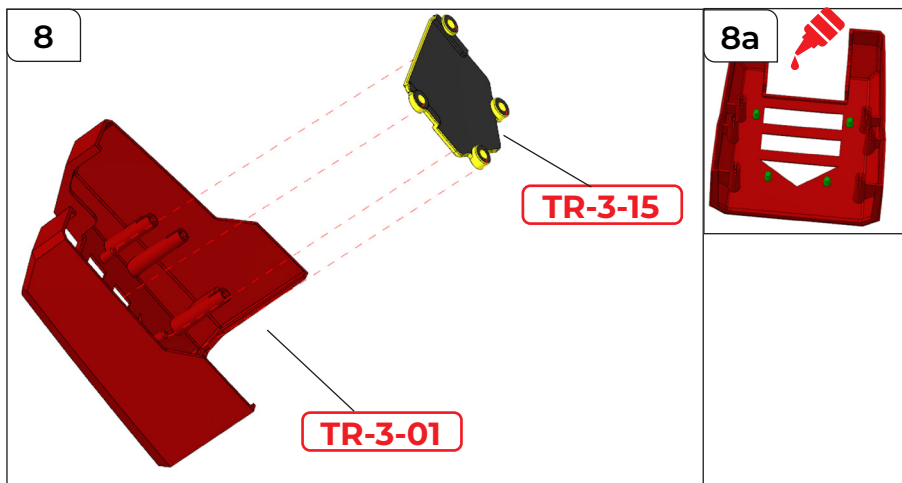

在將 TR-3-01 黏在 TR-3-15 之前，先在 TR-3-01 上塗一點膠水 (如圖 8a 中綠色的區域所示)。

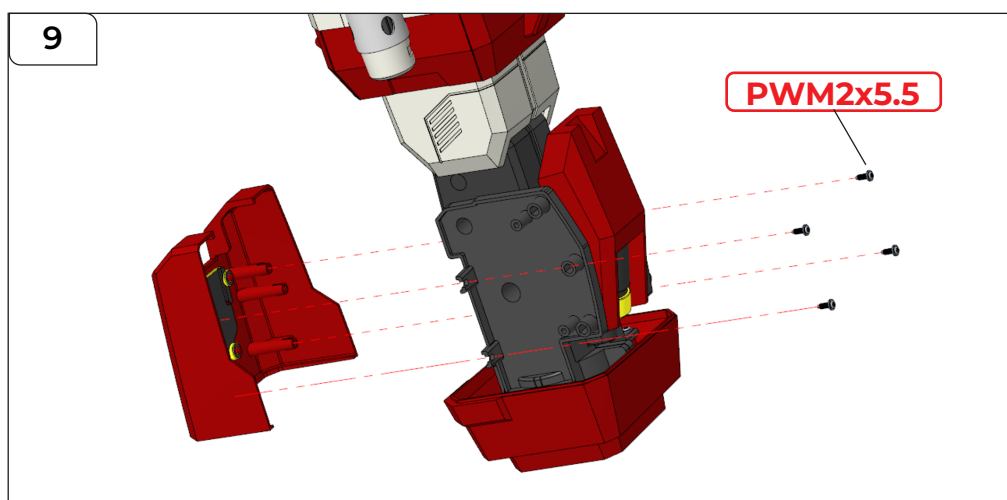

依照圖示將步驟 8 的組件連接到手臂。使用 4 顆 PWM2x5.5 mm 螺絲將其固定到位。

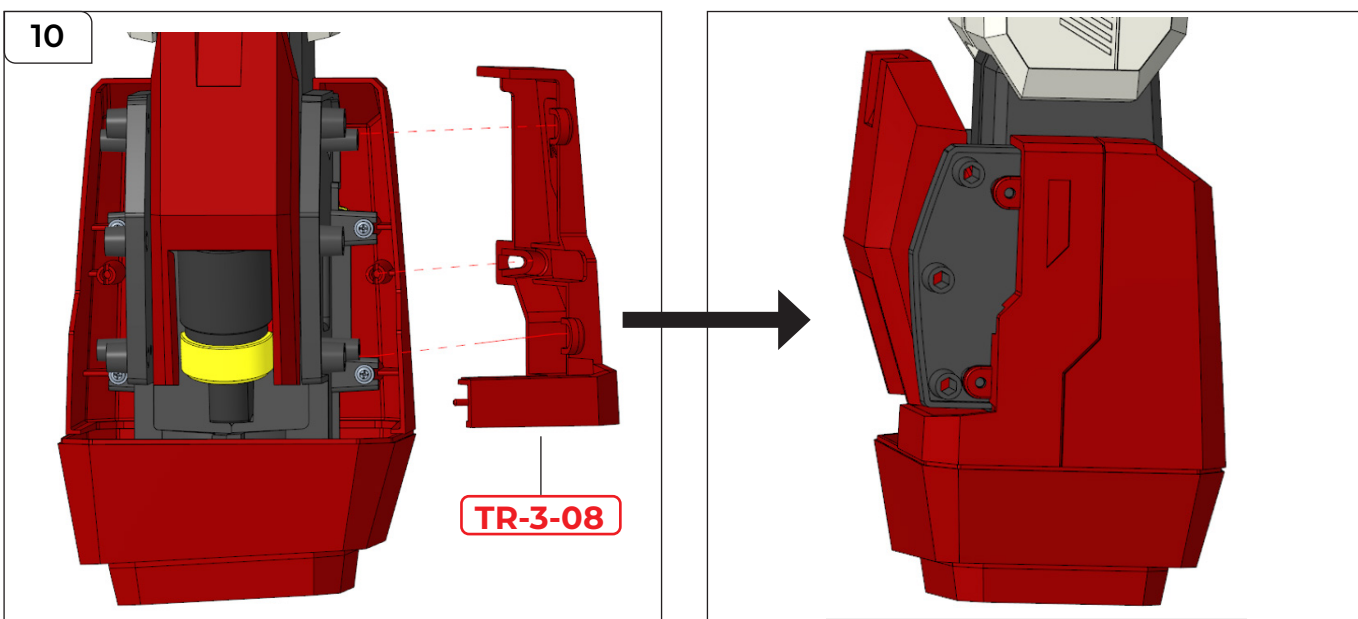

按照示意將 TR-3-08 附著到手臂上。

組裝左下臂

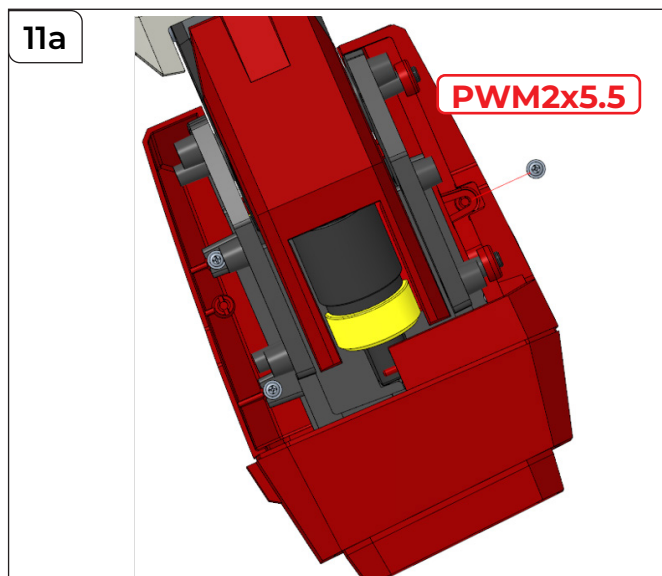
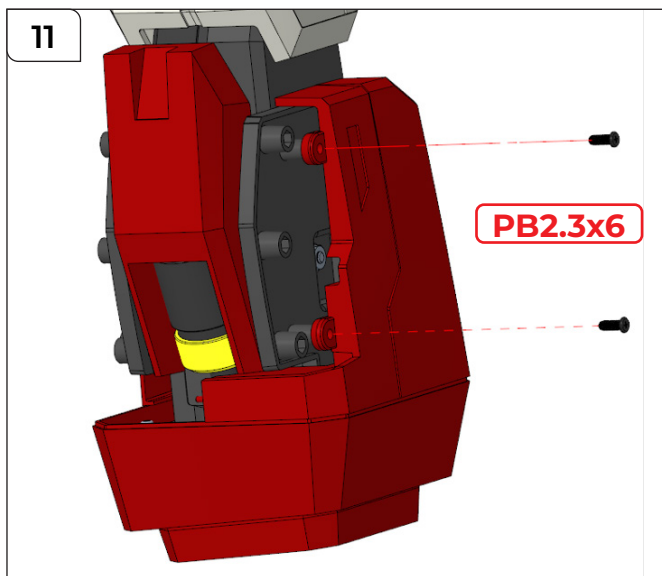

STEP 11

依照上面 11 圖和 11a 圖所示，使用 2 顆 PB2.3x6 mm 螺絲和 1 顆 PWM2x5.5 mm 螺絲將 TR-3-08 固定在手臂上。

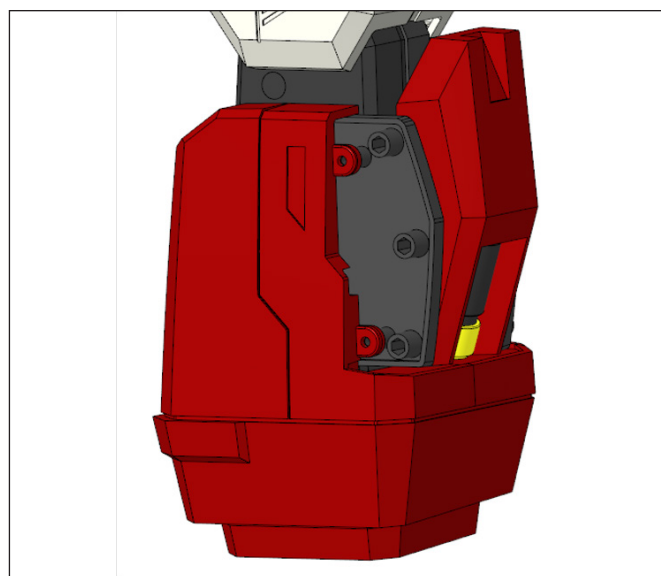
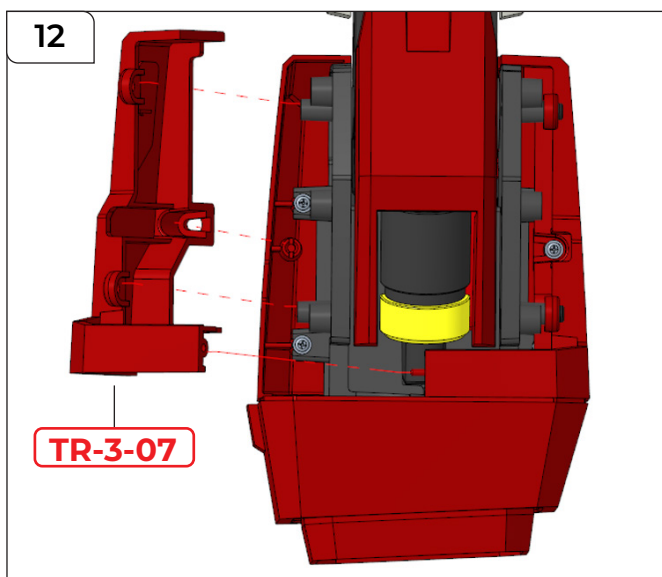

STEP 12

按照示意將TR-3-07附著到手臂的另一側。

組裝左下臂

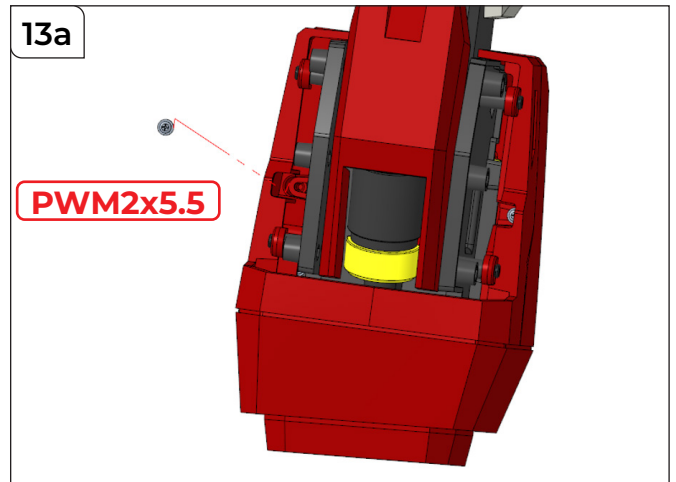
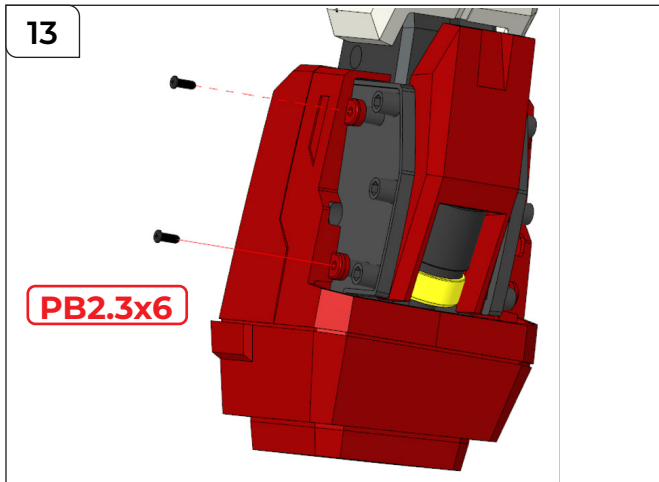

STEP 13

依照上面 13 圖和 13a 圖所示，使用 2 顆 PB2.3x6 mm 螺絲和 1 顆 PWM2x5.5 mm 螺絲將 TR-3-07 固定到手臂上。

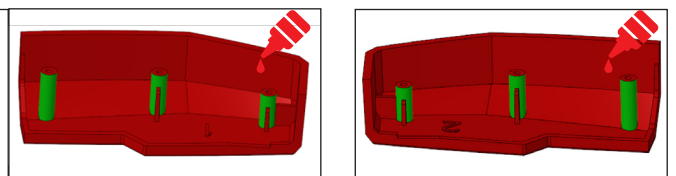
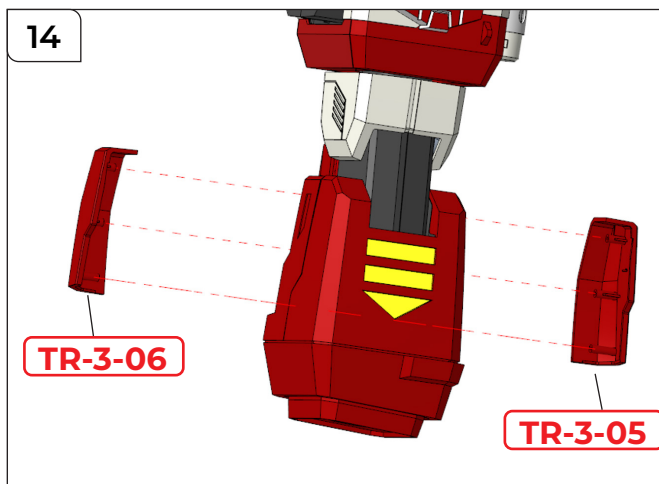

STEP 14

依圖示試裝 TR-3-05 和 TR-3-06。然後在將它們固定到位之前，塗上一點膠水 (上面圖片中綠色區域表示的位置)。

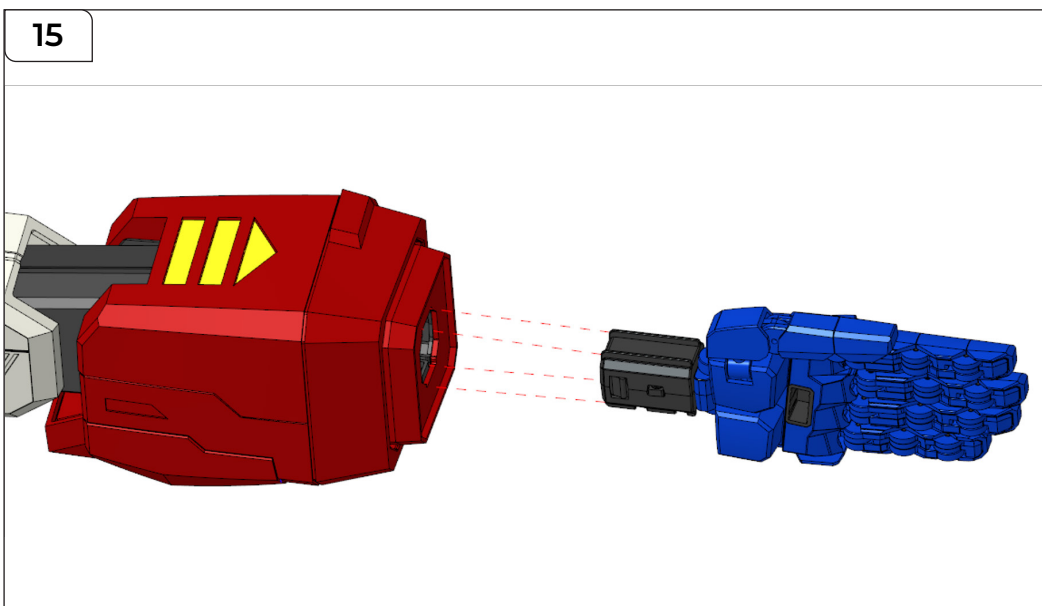

STEP 15

將手部組件按照圖示推入手臂組件的末端。

組裝左下臂

